

All drawings and related documents are the property of Ryder Architecture (Canada) Inc. and may not be reproduced in whole or in part without written permission. Drawings are based upon site information supplied by third parties and accuracy cannot be guaranteed. Do not scale this drawing. Do not use this drawing to calculate areas. Dimensions to be verified by the Contractor and such dimensions to be solely their responsibility. Work must comply with the relevant Building Codes, By-Laws and related documents. Drawing errors and omissions must be reported immediately to the Architect of Record.



Material Selection

- | | | | | | | | | | | | | | |
|--|---|--|--|--|---|--|---|--|-------------------------------------|--|---------------------------------------|--|-------------------------------------|
| | 1 - Medium Grey 1 1/2\"/>
Standing Seam Metal Cladding | | 3 - Dark Green Horizontal
Cementitious Siding | | 5 - Light Grey Vertical
Metal Cladding | | 7 - Wood Like Horizontal
Cementitious Cladding | | 9 - Dark Brown Metal
guards | | 11 - Dark Grey
Cementitious Trim | | 13 - Light grey
asphalt shingles |
| | 2 - Light Green Horizontal
Cementitious Siding | | 4 - Wood Like Vertical
Cementitious Cladding | | 6 - Dark Grey Vertical
Metal Cladding | | 8 - Black Window Frame | | 10 - Dark Brown Metal
Sun shades | | 12 - Wood Like
Cementitious Soffit | | |

Key Plan

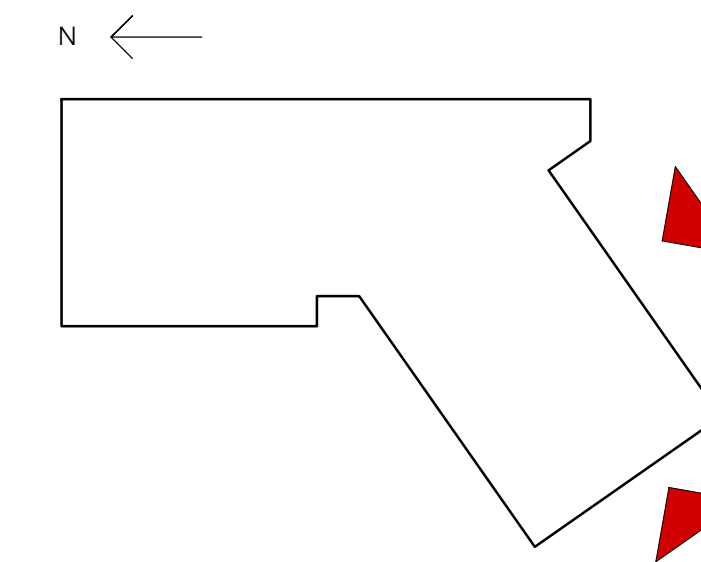

Issuance	Date
Final SD Submission	29 Nov 2024
Issued for Draft Rezoning Report	07 Jan 2025
Draft RZ/DP Pack and Consultant DD	06 Feb 2025
Coordination	

RECEIVED
DP1379
2025-FEB-27
Current Planning

Rev	Description	Date
DP	Issued for Rezoning and Development Permit	14 Feb 2025

Ryder

Ryder Architecture (Canada) Inc.
2350-1075 West Georgia Street
Vancouver BC V6E 3C9

www.ryderarchitecture.ca
info@ryderarchitecture.ca

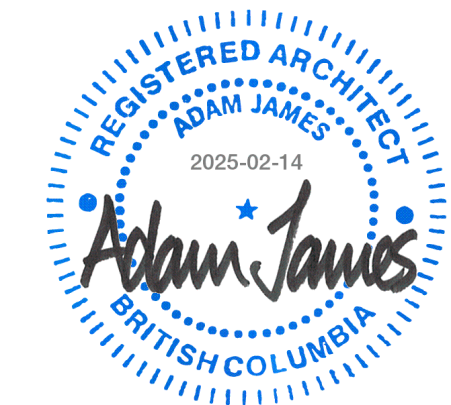

Project
**BC Housing and Island Health
Complex Care Housing**
1850 Boxwood Road, Nanaimo

Drawn by	Checked by	Status
ABL	AJA	DP
Project ID.	Project No.	Scale @
BCHNAV-NN	11589-00	As indicated

Site Elevations - Front Elevations

Drawing No.

A300

All drawings and related documents are the property of Ryder Architecture (Canada) Inc. and may not be reproduced in whole or in part without written permission. Drawings are based upon site information supplied by third parties and accuracy cannot be guaranteed. Do not scale this drawing. Do not use this drawing to calculate areas. Dimensions to be verified by the Contractor and such dimensions to be solely their responsibility. Work must comply with the relevant Building Codes, By-Laws and related documents. Drawing errors and omissions must be reported immediately to the Architect of Record.



Issuance	Date
Final SD Submission	29 Nov 2024
Issued for Draft Rezoning Report	07 Jan 2025
Draft RZ/DP Pack and Consultant DD	06 Feb 2025
Coordination	



RECEIVED
DP1379
2025-FEB-27
Current Planning

Rev	Description	Date
DP	Issued for Rezoning and Development Permit	14 Feb 2025

Ryder

Ryder Architecture (Canada) Inc.
2350-1075 West Georgia Street
Vancouver BC V6E 3C9

www.ryderarchitecture.ca
info@ryderarchitecture.ca



Material Selection

- | | | | | | | | | | | | | | |
|--|---|--|---|--|--|--|--|--|----------------------------------|--|------------------------------------|--|----------------------------------|
| | 1 - Medium Grey 1 1/2" Standing Seam Metal Cladding | | 3 - Dark Green Horizontal Cementitious Siding | | 5 - Light Grey Vertical Metal Cladding | | 7 - Wood Like Horizontal Cementitious Cladding | | 9 - Dark Brown Metal guards | | 11 - Dark Grey Cementitious Trim | | 13 - Light grey asphalt shingles |
| | 2 - Light Green Horizontal Cementitious Siding | | 4 - Wood Like Vertical Cementitious Cladding | | 6 - Dark Grey Vertical Metal Cladding | | 8 - Black Window Frame | | 10 - Dark Brown Metal Sun shades | | 12 - Wood Like Cementitious Soffit | | |

Key Plan

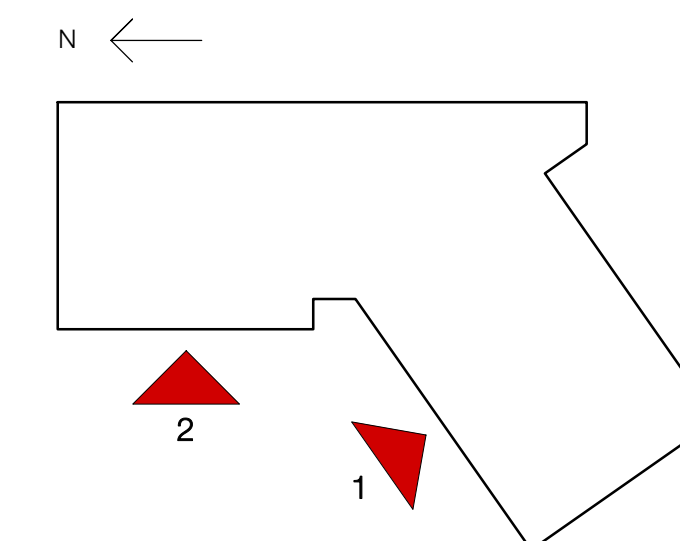

Project
BC Housing and Island Health
Complex Care Housing
1850 Boxwood Road, Nanaimo

Drawn by	Checked by	Status
ABL	AJA	DP
Project ID.	Project No.	Scale @ 22x34
BCHNAV-NN	11589-00	As indicated

Drawing
Site Elevations - Courtyard Facing

Drawing No.

A301

All drawings and related documents are the property of Ryder Architecture (Canada) Inc. and may not be reproduced in whole or in part without written permission. Drawings are based upon site information supplied by third parties and accuracy cannot be guaranteed. Do not scale this drawing. Do not use this drawing to calculate areas. Dimensions to be verified by the Contractor and such dimensions to be solely their responsibility. Work must comply with the relevant Building Codes, By-Laws and related documents. Drawing errors and omissions must be reported immediately to the Architect of Record.



Issuance _____ Date _____

Final SD Submission 29 Nov 2024
 Issued for Draft Rezoning Report 07 Jan 2025
 Draft RZ/DP Pack and Consultant DD 06 Feb 2025
 Coordination _____



RECEIVED
DP1379
2025-FEB-27
 Current Planning

Rev Description Date
 DP Issued for Rezoning and Development Permit 14 Feb 2025

Ryder

Ryder Architecture (Canada) Inc.
 2350-1075 West Georgia Street
 Vancouver BC V6E 3C9

www.ryderarchitecture.ca
 info@ryderarchitecture.ca



Material Selection

- Standing Seam Metal Cladding
- 3 - Dark Green Horizontal Cementitious Siding
- 5 - Light Grey Vertical Metal Cladding
- 7 - Wood Like Horizontal Cementitious Cladding
- 9 - Dark Brown Metal guards
- 11 - Dark Grey Cementitious Trim
- 13 - Light grey asphalt shingles
- 2 - Light Green Horizontal Cementitious Siding
- 4 - Wood Like Vertical Cementitious Cladding
- 6 - Dark Grey Vertical Metal Cladding
- 8 - Black Window Frame
- 10 - Dark Brown Metal Sun shades
- 12 - Wood Like Cementitious Soffit

Key Plan

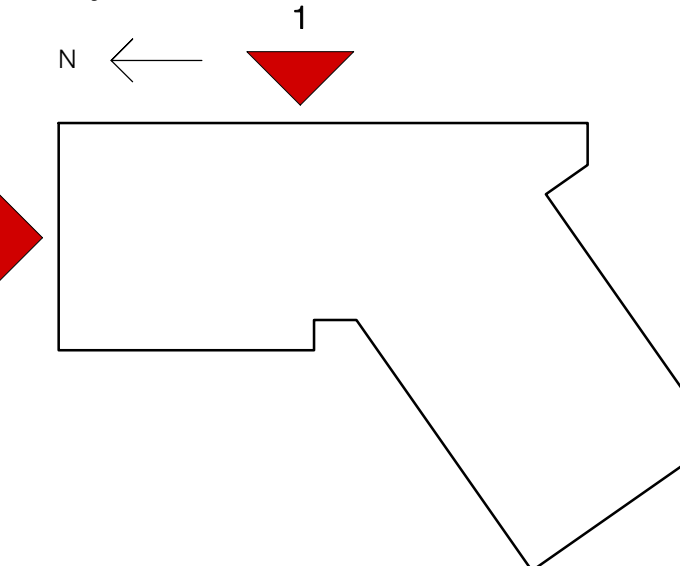

Project
BC Housing and Island Health
Complex Care Housing
1850 Boxwood Road, Nanaimo

Drawn by **ABL** Checked by **AJA** Status **DP**
 Project ID **BCHNAV-NN** Project No. **11589-00** Scale @ 22x34
 As indicated

Drawing
Site Elevations - Rear and Side Facing

Drawing No.

A302